

ITEM NO.	PART NUMBER	QTY.
1	M10 x 16 SOCKET HEAD BUTTON SCREW	1
2	HORIZONTAL SUPPORT	2
3	TINE POCKET	4
4	REAR VERTICAL SUPPORT	1
5	OUTER BEAM	1
6	END CAP 150 x 100 RHS	1
7	LUG	6
8	FRONT VERTICAL SUPPORT	1
9	GUIDE PLATE	1
10	SPLI LINK	1
11	8mm CHAIN LINK	2
12	LOCATION PIN	1
13	INNER BEAM	1
14	END CAP 125 x 75 RHS	1
15	INNER GUIDE PLATE	1
16	HOOK PIN	1
17	6T PEWAG SWIVEL HOOK	1

NOTE:

1. ALL WELDING TO COMPLY WITH AS1554.1 CAT SP
2. ALL WELDS 6mm C.F.W.
3. ALL STEEL PLATE TO COMPLY WITH AS3678
4. ALL STEEL HOLLOW SECTIONS TO COMPLY WITH AS1163 GRD350
5. COMPLIES WITH AS2359.1 WHERE PRACTICAL
6. FINISH POWDER COAT GOLDEN YELLOW
7. TARE WEIGHT 125KG

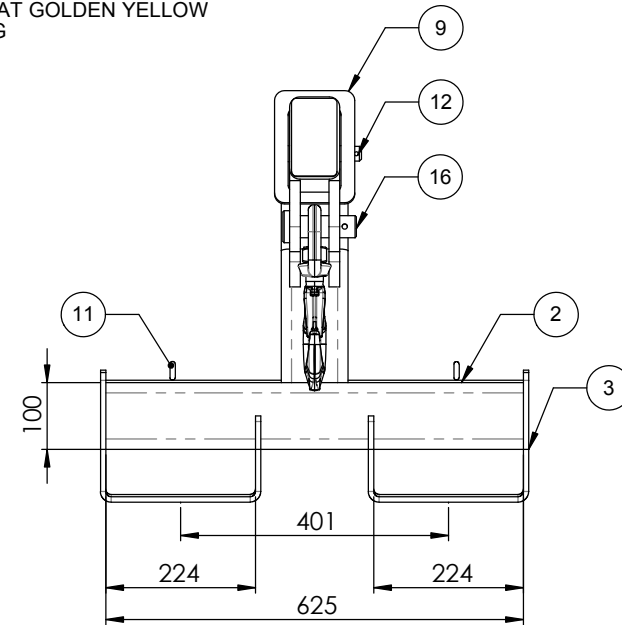
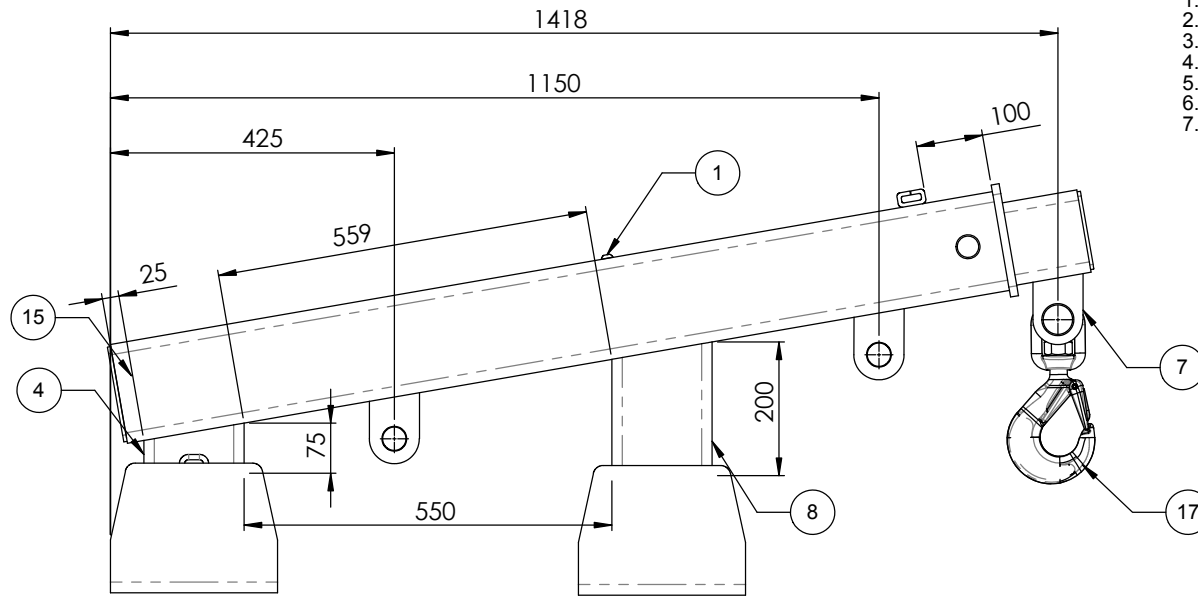

POSITION	EXTENSION	WLL
1.	425mm	4500KG
2.	1150mm	4500KG
3.	1413mm	3000KG
4.	1773mm	1250KG
5.	2133mm	700KG

D.O.T.
ENGINEERING

1 / 57 PARAMOUNT DRV
WANGARA. 6065
WESTERN AUSTRALIA.

TEL: (08) 9302 4166

FAX: (08) 9302 4099

THIS DRAWING AND THE INFORMATION ON IT
REMAINS THE PROPERTY OF DOT ENGINEERING
WRITTEN PERMISSION MUST BE OBTAINED FROM
DOT ENGINEERING TO COPY OR REPRODUCE
THE WHOLE OR PART OF THIS DRAWING.

DRAWN

RM

TITLE FORKLIFT JIB ASSEMBLY

CHECKED

SIZE 4.5T WLL

SCALE 1:8

DATE 12-Mar-11

APPROVED

PROJECT FORKLIFT ATTACH.

DWG 10163 - 1

REV 1