

ITEM NO.	PART NUMBER	QTY.
1	BODY	1
2	TOP PLATE	1
3	6mm SPLIT LINK	1
4	RESTRAINT PIN	1
5	6mm x 25mm Roll Pin	1

**TARE WEIGHT 32KG EACH**

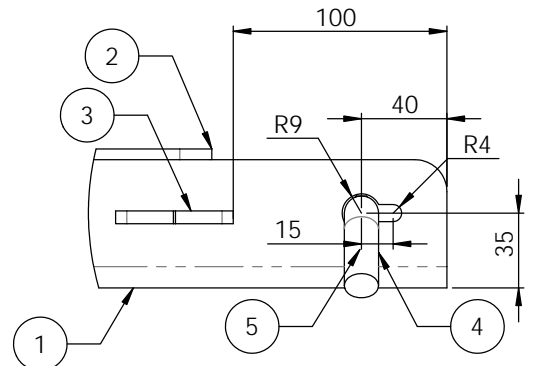

**DETAIL B  
SCALE 2 : 5**

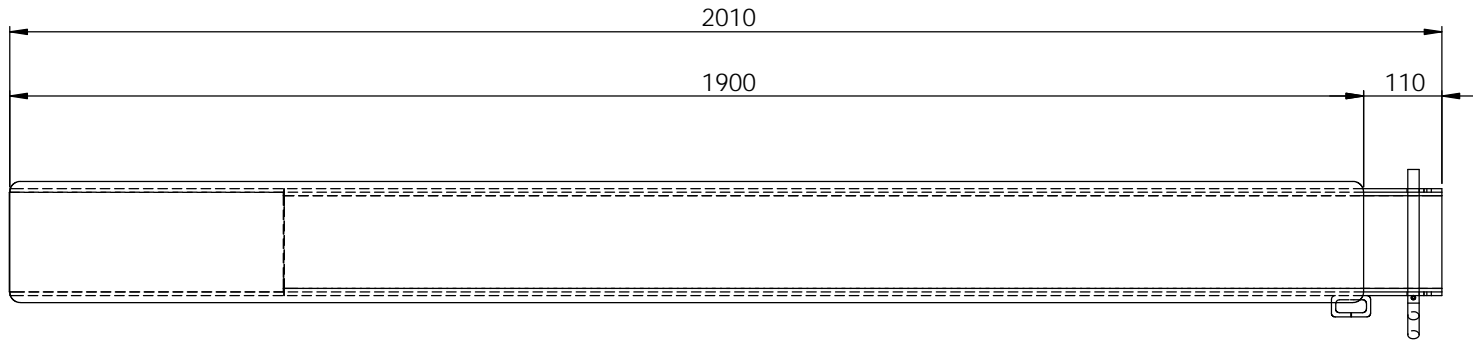
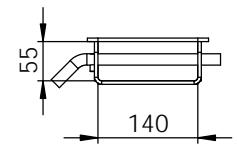
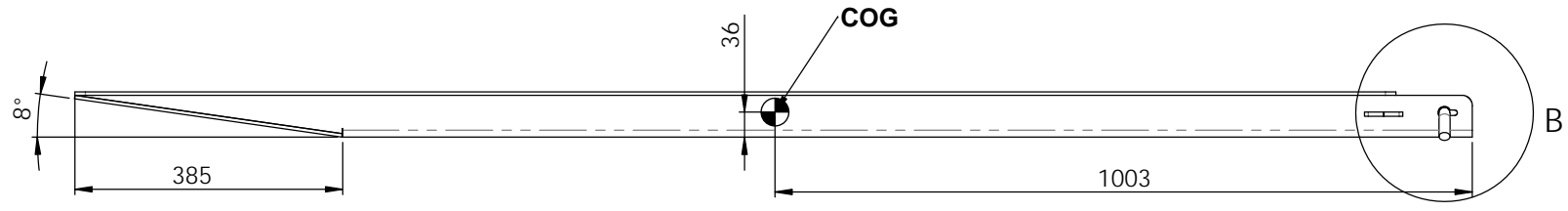

**D.O.T.  
ENGINEERING**

1 / 57 PARAMOUNT DRV  
WANGARA. 6065  
WESTERN AUSTRALIA.

**TEL: (08) 9302 4166**  
**FAX: (08) 9302 4099**

THIS DRAWING AND THE INFORMATION ON IT  
REMAINS THE PROPERTY OF DOT ENGINEERING  
WRITTEN PERMISSION MUST BE OBTAINED FROM  
DOT ENGINEERING TO COPY OR REPRODUCE  
THE WHOLE OR PART OF THIS DRAWING.

DRAWN	RM	TITLE	1900mm FORKLIFT EXTENSION SLIPPERS		
CHECKED		SIZE	2.5T PER PAIR	SCALE	1:7.5
APPROVED		PROJECT	FORKLIFT ATTACH.	DWG	10233 - 1
				DATE	16-Apr-11
				REV	3