

**NOTE:**

1. ALL WELDING TO COMPLY WITH AS1554.1 CAT SP
2. ALL WELDS 10mm CONTINUOUS FILLET WELDS U.O.N
3. ALL STEEL PLATE TO COMPLY WITH AS3678
- 4. TARE WEIGHT 894KG EACH EXCLUDING SHACKLES**
5. FINISH HOT DIP GALVANISED
6. PROOF LOAD AND MARKINGS TO COMPLY WITH AS4991
7. 150T GRD "S" SAFETY BOW OR SLING SAVER SHACKLES TOP & BOTTOM
8. PIPE  $\varnothing 609.6 \times 12.7$  AS1163 GRD. C350 PIPE
9. BOLTS TO JOIN PIPES ARE M27 x 110 GRD 8.8 WITH 950Nm TORQUE ALL BOLTS

ITEM NO.	PART NUMBER	QTY.
1	10996-BODY	1
2	10996-LUG PLATE	1
3	10996-CHEEK PLATE	1
4	10996-FRONT PLATE	1
5	CHEEK PLATE	1
6	10996-GUSSETT	2
7	10996-SELF WEIGHT LIFTING LUG	1
8	10996-BACK PLATE	1
9	10996-BRACING FOR BACK PLATE	4
10	10996-LH END CAP	1
11	10996-RH END CAP	1
12	10996-OPERATION PLATE	1
13	150T SHACKLE	2

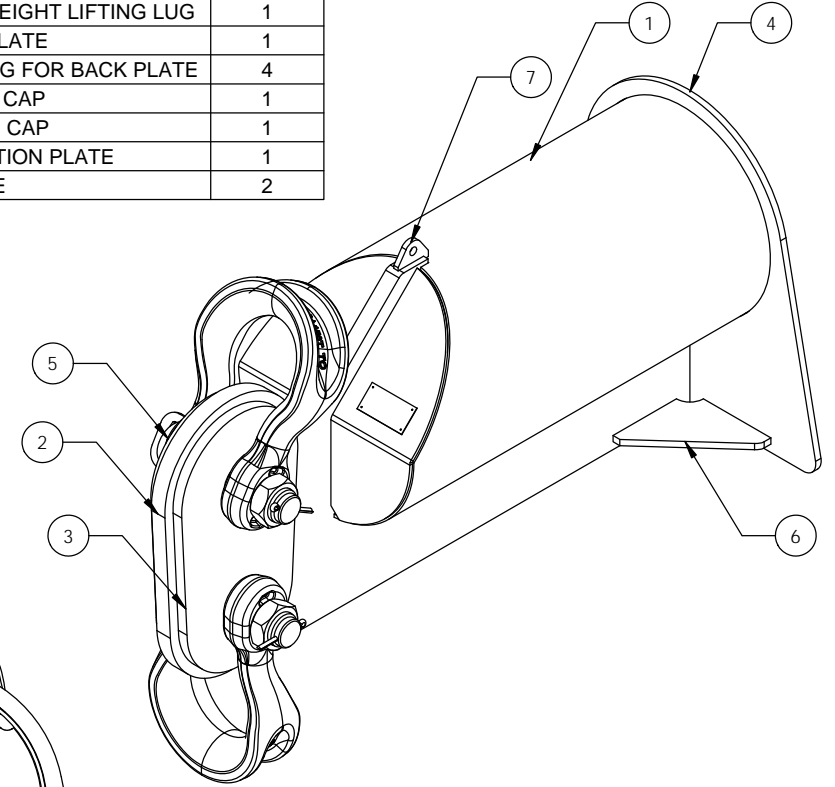
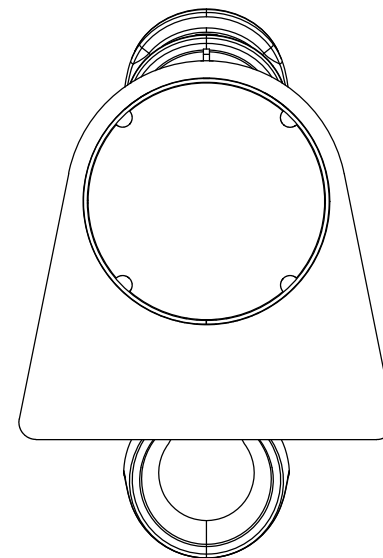
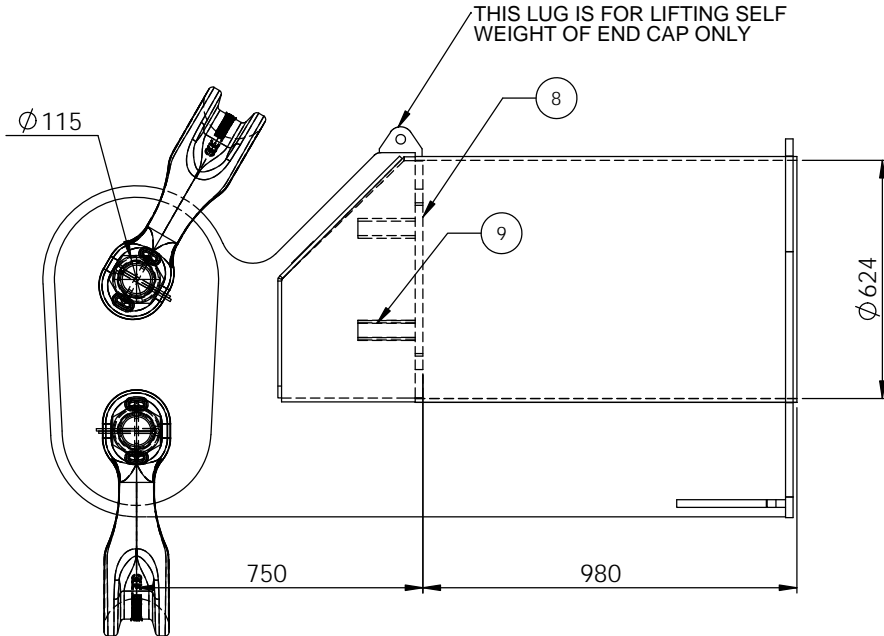
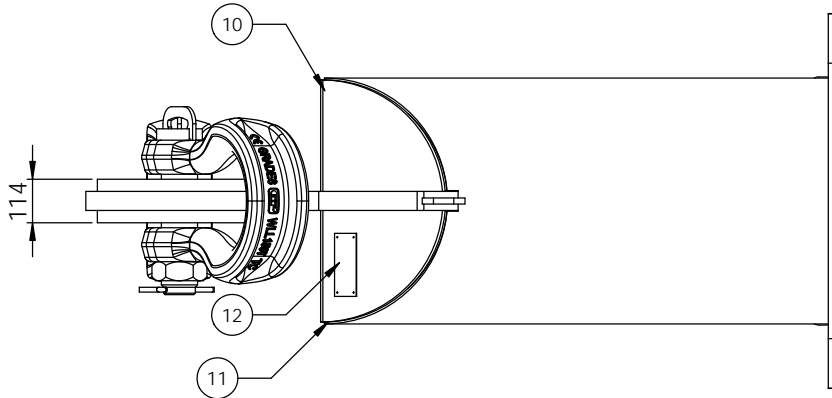

SLING ANGLE	SPREADER BEAM CENTRES	WLL
60°	29-30 METERS	65T
60°	27-28 METERS	90T
60°	24-26 METERS	140T
60°	23-24 METERS	180T
60°	15-22 METERS	250T

**D.O.T.  
ENGINEERING**

1 / 57 PARAMOUNT DRV  
WANGARA. 6065  
WESTERN AUSTRALIA.

**TEL: (08) 9302 4166**

**FAX: (08) 9302 4099**

THIS DRAWING AND THE INFORMATION ON IT  
REMAINS THE PROPERTY OF DOT ENGINEERING  
WRITTEN PERMISSION MUST BE OBTAINED FROM  
DOT ENGINEERING TO COPY OR REPRODUCE  
THE WHOLE OR PART OF THIS DRAWING.

DRAWN	RM	TITLE	SPREADER BEAM END CAP TO SUIT 600 N.B. PIPE		
CHECKED		SIZE	250T WLL PER PAIR	SCALE	1:14
APPROVED		PROJECT	BEAMS	DWG	10996 - 1
				DATE	10-May-11
				REV	0